

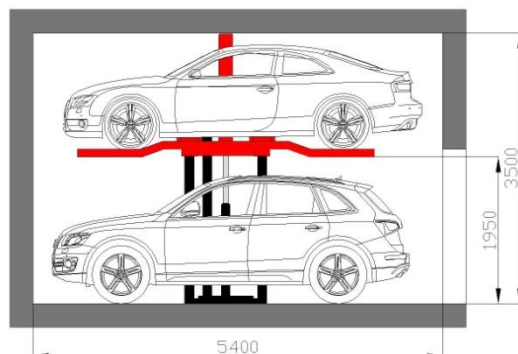

FIMAC

LIFT TO THE FUTURE

SCHEDA TECNICA H BOX Raddoppiatore posto auto Monocolonna

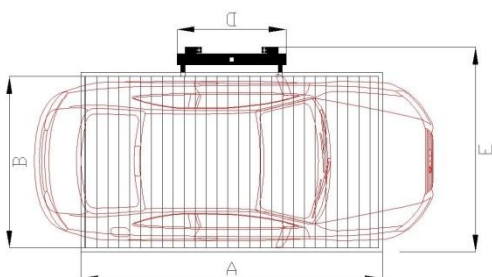
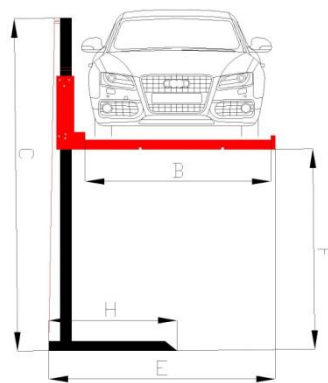
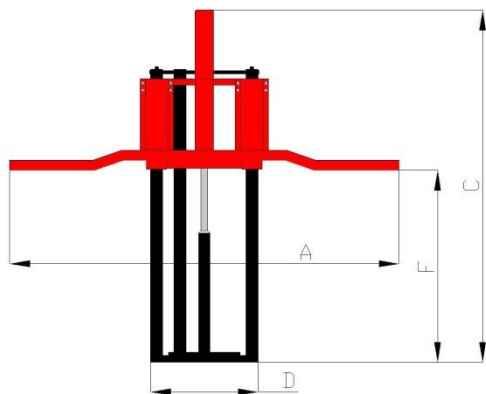

MODELLI B BOX: S , L, XL

A: Lunghezza piattaforma	3500 mm			
B: Larghezza utile pianale	S: 1850 mm.	L: 1900 mm.	XL: 1950 mm.	XXL: 2000 mm.
C: Altezza colonna	3500 mm.			
D: Larghezza colonna	1290 mm.			
E: Larghezza totale	S: 2320 mm.	L: 2370 mm.	XL: 2420 mm	XXL: 2470
F: Altezza utile	1950 mm.			
Motore	Volt 220 kw 1,5			
Portata	2000 Kg.			

FIMAC LIFT S.r.l.

Via Montessori 16 - 25013 Carpenedolo (BS)

Tel.: +39 030 13885958

Mobile: +39 338 8384883

info@fimaclift.com

PEC: fimacliftsr@legalmail.it

fimaclift.com

P. IVA e C.F.: 04432320986

Cap. Soc.: € 20.000,00 i.v.

N° Reg. Imp. di BS: 04432320986

REA: BS-614466





FIMAC

LIFT TO THE FUTURE

TABELLA DEI CARICHI E MISURE PER INCASSO PIEDE MONOCOLONNA

N1	300 Kg.
N2	2500 Kg.

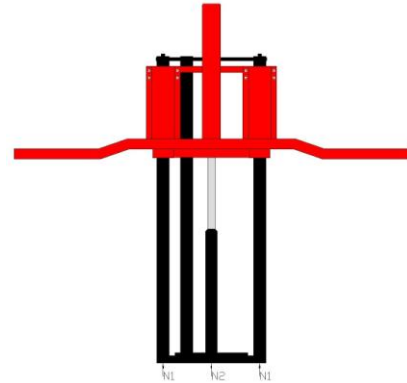
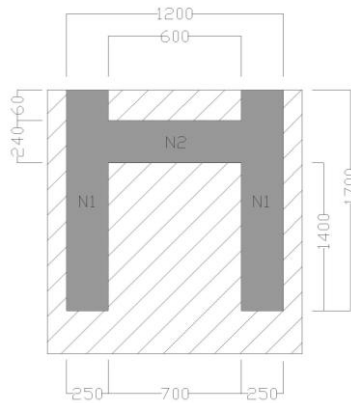

ALCUNE INSTALLAZIONI

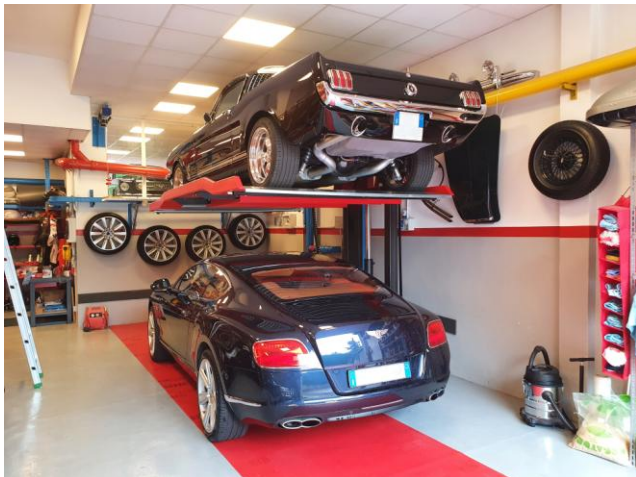

FIMAC LIFT S.r.l.

Via Montessori 16 - 25013 Carpenedolo (BS)

Tel.: +39 030 13885958

Mobile: +39 338 8384883

info@fimaclift.com

PEC: fimacliftsr1@legalmail.it

fimaclift.com

P. IVA e C.F.: 04432320986

Cap. Soc.: € 20.000,00 i.v.

N° Reg. Imp. di BS: 04432320986

REA: BS-614466